

decakila

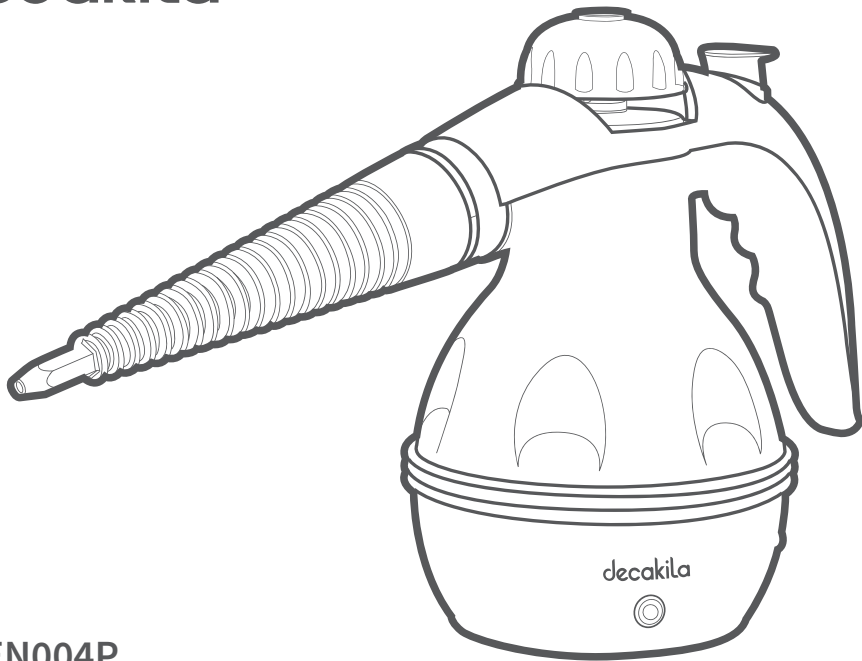

KUEN004P
STEAM CLEANER



CONTENTS

IMPORTANT SAFETY INSTRUCTIONS	01
TECHNICAL DATA	04
ELECTRICAL WIRING	04
DESCRIPTION OF THE APPLIANCE	05
CHARACTERISTICS	06
ACCESSORIES	06
HOW TO USE	06
MAINTENANCE	08
TROUBLESHOOTING	09

IMPORTANT SAFETY INSTRUCTIONS

Warning! Beware that the nozzle gets very hot during operation.

- Danger of scalding! Do not come into contact with withdrawing steam.
- Always keep this appliance away from children! Children shall not use the product and shall not play with it.
- Do not leave the appliance unattended while it is switched on. Unplug the appliance from the mains supply socket before each cleaning/maintenance and before you fill/empty the water tank.
- **WARNING:** This appliance can be used by persons with reduced physical, sensory or mental capabilities or lack of experience and knowledge if they have been given supervision or instruction concerning use of the appliance in a safe way and understand the hazards involved. Children shall not play with the appliance.
- After removing the packing materials, check the integrity of the appliance. The packing materials (plastic bags, polystyrene foam, etc.) must be kept out of the reach of children because they are potential source of danger; dispose them according to current regulations, in dedicated containers for different disposal.
- The manufacturer can not be held responsible for any damage caused by improper, incorrect and irresponsible and or repair by unqualified personnel.
- Keep the cord away from heating surfaces.
- Do not use with wet feet or wet hands
- If the supply cord is damaged, it must be replaced by the manufacturer, its service Authorized Service Center in order to avoid a hazard.
- Before connecting the appliance make sure that the mains voltage corresponds to the data specified on the label. The appliance can be damaged if the voltage is not correct..
- Never immerse the product in water or any other liquid.
- Product can be damaged if it has fallen down or it is subjected to shocks. Don't use it in case of falls or in case of leakage of water
- Keep the product t out of reach of children.
- The use of extension leads not recommended by the manufacturer may cause damage or accidents.

- If the power cord is damaged, it must be replaced either by the manufacturer or by a Technical Assistance Centre or similarly qualified person, so as to prevent any risk.
- Never place energised parts in contact with water: danger of short circuits!
- Never use to clean up liquids.
- Never touch the appliance with wet hands or feet.
- Never use the appliance with bare feet.
- Unplug the appliance from the mains power before carrying out any cleaning or maintenance.
- Never place the appliance in water or other liquids.
- Make sure that the power cord is not in contact with hot or sharp surfaces.
- In case of breakdowns, failures or suspected faults after a fall or being dropped, unplug the appliance from the mains immediately. Never use a faulty appliance.
- Repairs may be done by an authorised Assistance Centre only.
- Don't leave the product unattended when it is plugged. Disconnect the plug any time product is not in use.
- Do not place heavy objects on the cables or heat sources close to them . The cables may be damaged;
- This product is intended solely for domestic use. Unplug the appliance when it is upside down or resting;
- Before carrying out any cleaning or maintenance, disconnect the appliance from the mains by removing the plug.
- In case of abnormal situations immediately turn off the power and contact your dealer or service center;
- Do not use this unit connected to programmers, external timer , remote control system of separate timer or any other device that can switch automatically;
- Do not use power sockets flying or damaged cables;
- When you connect or disconnect the power firmly pulls the plug to avoid electric shock, short circuit or fire;
- Avoid the contact of the product with water or any other liquid.
- Do not expose to outdoor elements
- Do not attach safety switches with tape, for fire hazard;
- It is absolutely prohibited to disassemble or repair the unit by the danger of electric shock if necessary contact your dealer or

service center;

- Do not use the appliance near a bathtub, shower, swimming pool;
- Do not use the product near flammable objects;
- Before connecting to the mains supply, make sure the voltage is correct as reported on the label of the product and that the installation complies with current regulations.
- Do not touch the power connection with wet hands;
- Do not use the product for purposes other than those for which it was built;
- The appliance must be kept out of children's reach and can't be used by children.
- In order to ensure safety, the appliance should only be assembled as set out in the instructions for use and connected and operated in accordance with the model plate. Use only the accessories, which are recommended by manufacturer.
- Examine the appliance before use in order to detect signs of damage. Do not operate if the appliance, its power cord or plug shows any signs of damage. In order to comply with safety regulations and to avoid hazards out by qualified personnel. If repair is needed, send the appliance to one of our customer service center.
- The appliance can't be operated, if the power cord or plug is damaged. Do not use the power cord to carry the appliance. Beware that the power cord does not come into contact with hot surfaces.
- Check the appliance and the mains wire before each use for perfect status.
- After the use unplug the appliance from the mains supply socket. Never leave the product unattended when powered.
- During the operation keep the openings and the air outlet always free for good air ventilation.
- Make sure that the appliance does not be tilted over 45 during the operation. When the appliance is in operation the nozzles should not be directed toward humans, animals or plants.
- Fill only water in the appliance. Descaler, perfume, Detergent etc. should not be used with this appliance, in order to avoid damages of the appliance.
- Filling the water:
 - a. Unplug the appliance from the mains supply socket.
 - b. Press the steam button to release the residual pressure.

c. Let the appliance cool down.

d. Press the steam button again to release the residual pressure.

e. Release the safety lid and remove it in about 5 minutes.

Warning! The appliance heats up in the operation therefore do not touch the hot surface; use only the grasps or buttons. Always let the appliance cool down, before accessories are removed or attached from it.

- If the supply cord is damaged, it must be replaced by the manufacture or its service agent or a similarly qualified person in order to avoid a hazard.
- Before each cleaning/maintenance unplug the appliance from the mains supply socket and let it cool down enough time.



WARNING: HOT STEAM – BURN HAZARD

TECHNICAL DATA

Rated voltage	120V~ 50/60Hz
Power	1000W
Operating temperature	-20°C a 50°C
Dimensions	25x13x22cm
Operating pressure	300Kpa

ELECTRICAL WIRING

This appliance must be attached to a mains supply socket with grounding; therefore it is equipped with a mains cable with ground wire.

Warning! Only a qualified person is allowed to check your mains supply socket. Never try to modify or change the mains plug of the appliance.

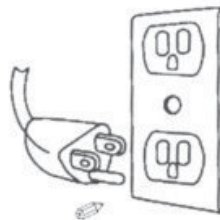

DESCRIPTION OF THE APPLIANCE

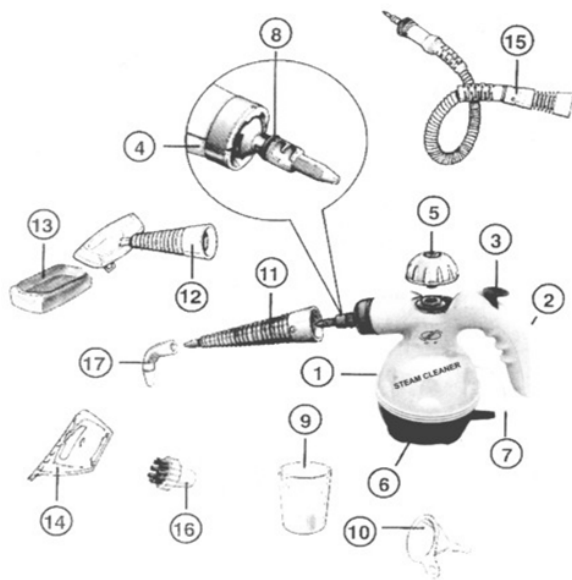

1. Housing
2. Handle
3. Steam button
4. Accessory connection
5. Safety lid
6. Power control lamp
7. Mains cable
8. Rubber scaling
9. Measuring nozzle
10. Funnel
11. Straight nozzle
12. Scrubbing brush
13. Cloth
14. Window wiper
15. Hose
16. Brush
17. Curved nozzle

CHARACTERISTICS

This appliance is everywhere applicable and very flexible; in addition you need only fill water in it. It cleans, degreased and disinfects completely without chemistry (over 100 °C) and it suitable for different materials and areas e.g. windows, clothing, garden furniture, bicycles, tiles etc. Warning! Never direct this appliance at humans or animals. This appliance is also ideal for disinfecting of refrigerators, baths, smell distance of clothing and mite fight in mattresses, pillows and carpets.

ACCESSORIES



Brush: for kitchen, tiles etc.



Scrubbing brush: for curtains and clothing etc. be used together with cloth and hose.



Window wiper: for window, mirror, glass, door etc.
Caution! Do not uses on cold glass directly.



Straight nozzle: for joints, shelf etc.



Curved nozzle: for toilets and the areas, this is difficulty to reach.



Hose: Ideal to the extension of the accessories

HOW TO USE

Cautions! This appliance should not be used directly on soft plastics, non pre-treated wood and cold glass.

Caution! Steam could damage the furniture surface. For a safe work please execute a test run before. Pay attention to the appropriate maintaining notes of the manufacturer.

ASSEMBLY

(Do not attach the appliance to the power supply until point 7.)

Warning! After the use press the steam button to reduce the internal pressure sufficiently. Then you can release the safety lid.

1.Release the safety lid.

2.Fill appropriate water into the water tank. Please use the provided measuring cup and the funnel. It is recommended that you fill the tank to max 2/3 full. Note: Never fill descaler, perfume

or detergent into the water tank, in order to avoid damages of the appliance.

3. Close the safety lid again.

4. Put the desired accessory (nozzle, hose, scrubbing brush etc.) on the appliance: set the accessory on the connection and press it up to the rubber sealing. Turn the accessory in the clockwise direction, until it locks into the position. (Figure)

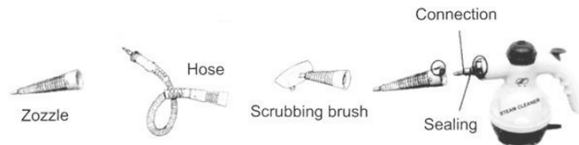

5. The brush and the curved nozzle:

The brush and the curved nozzle can be assembled on the hosing, with the hose or the straight nozzle. (Figure)

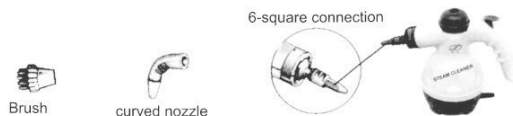

6. Window wiper:

Warning! Do not operate this appliance directly on cold glass.

The window wiper must be rattaché to the scrubbing brush. Assemble the scrubbing brush in the appliance or the hose at first. Take off the cloth from the scrubbing brush and connect with window wiper to the brush by the two hinges (figure). The window wiper can be dismantles easily by loosening the hinges again.

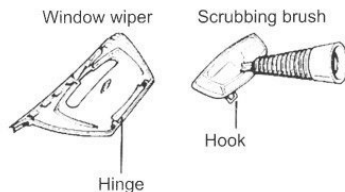

OPERATION

7. Attach the appliance to the mains supply and the control lamp lights up. As soon as the preheating (about 3-4 min) is terminated, the control lamp goes out.

Make sure that you can not switch the appliance on during the preheating process. Switch the appliance on and move it slowly over the surface, which is to be cleaned. It is recommended that

the distance between the nozzle and the surface amount to 2-3 cm.

It is normal that the control lamp switched on and off during the process, since the thermostat controls the heating element automatically.

Warning! The appliance can not be tilted over 45°C during the operation. Direct the appliance never toward humans, animals or plants.

8. Refilling the water tank:

Unplug the appliance from the mains supply socket. Press the steam button and release the internal pressure completely. Wait approx. 3 minutes and release the safety lid slowly. After the appliance is cooled down, fill the water tank up to 2/3 full. You can use the provided funnel and the measuring cup.

Close the safety lid and attach the appliance to the mains supply again.

Warning! Before you release the safety lid, make sure that the internal pressure is sufficiently reduced.

9. After the operation unplug the appliance from the mains supply socket and empty the water tank.

10. Descaling: In order to maintain the excellent quality of your cleaner, we recommend you to descale the appliance at regular intervals (once monthly). Make sure that not any vinegar or other descaler should be used.

Fill the water tank only with water. Vibrate the appliance by hand

and empty the tank afterwards.

Warning! Never immerse the appliance into water.

MAINTENANCE

This appliance requires with normal operation conditions not any special maintenance.

Do not try to repair the appliance. Repairs of electrical appliances must be carried out by qualified personnel.

TROUBLESHOOTING

Problem	Cause	Advice
Appliance does not start	<ul style="list-style-type: none"> • Appliance not plugged correctly • Mains supply socket damaged • Fuse burnt • No water in tank 	<ul style="list-style-type: none"> • Attach the appliance to mains supply socket again • Check the socket • Change the fuse • Fill water in tank
No steam	No water in tank	Fill water in tank
Water runs our from nozzle	<ul style="list-style-type: none"> • Too much water in the tank • Appliance too strongly tilted • Appliance not hot enough 	<ul style="list-style-type: none"> • Reduce water • Hold the appliance correctly • Let the appliance heat up
Water cooks while filling in	Water tank still very hot	<ul style="list-style-type: none"> • Let the appliance cool down • Use the funnel
Accessory comes loose	Accessory not correctly attached	Attach the accessory again
Other problems	Appliance damaged	Contact the customer service

Disposal of old electrical & electronic equipment (Applicable in the European Union and other European countries with separate collection systems)

This symbol on the product or in its packaging indicates that this product shall not be treated as household waste. Instead it shall be handed over to the applicable collection point for the recycling of electrical and electronic equipment. By ensuring this product is disposed of correctly, you will help prevent potential negative consequences for the environment and human health, which could otherwise be caused by inappropriate waste handling of this product. The recycling of materials will help to conserve natural resources. For more detailed information about recycling of this product, please contact your local city office, your household waste disposal service or the shop where you purchased the product.

negativas para el medio ambiente y la salud humana que podrían derivarse de la incorrecta manipulación de este producto. El reciclaje de materiales ayuda a conservar las reservas naturales. Para recibir información detallada sobre el reciclaje de este producto, por favor, contacte con su ayuntamiento, su punto de recogida más cercano o el distribuidor donde adquirió el producto.





decakila



decakila



decakila

Made in China Jiangsu China. 2021.D01

www.decakila.com Global Links Technology Co. Pte. Ltd.