

**ninebot<sup>®</sup>**

Engine Speaker User Manual



## **Welcome**

Thank you for choosing Ninebot Engine Speaker (hereinafter referred to "the speaker"). This product can be connected to mobile phones to play music, and can also be connected to many Segway-Ninebot vehicle models. When connected to vehicles, it can simulate different engine sound effects.

Enjoy these interesting and cool sound effects.

**ninebot<sup>®</sup>**

The manufacturer reserves the right to make changes to the product and update this manual at any time. Product parameters are subject to change without prior notice.

Visit [www.segway.com](http://www.segway.com) to download the latest user materials



User Manual



The Speaker

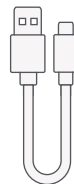

USB Type-C Charger Cable

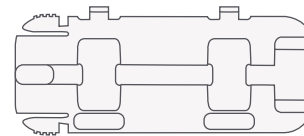

Base

\*Please check the packaging contents carefully. In case of any missing or damaged items, please call the after-sales service.

# Contents

1 Product Diagram	1
2 Installation	2
3 Connect to a Vehicle (Vehicle Mode)	3
4 Connect to a Mobile Phone (Music Mode)	4
5 Charging	4
6 Button Functions	5
7. Meanings of Indicators	5
8 Applicable Models	5
9. Specifications	6
10. FAQs	6
11. Precautions	7
12. Trademarks and Legal Statements	7
13. After-sales Policy	8

# 1 Product Diagram

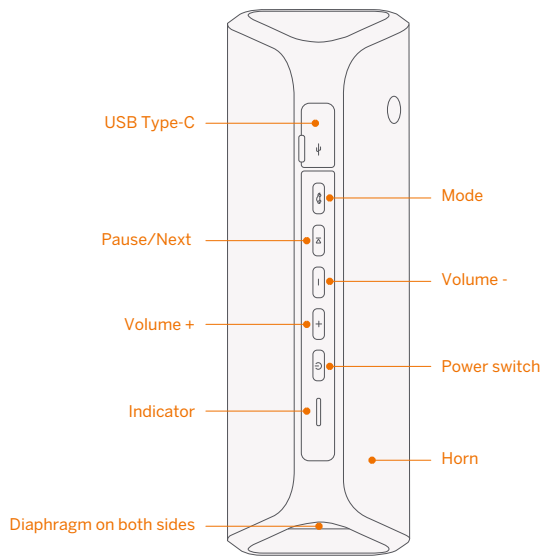

Top view

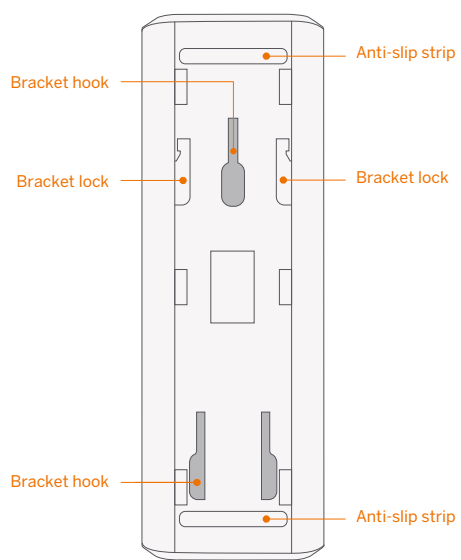

Bottom view

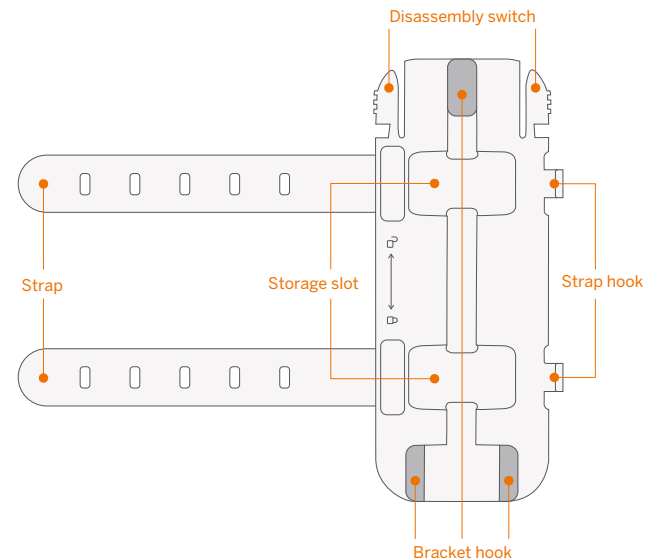

Base

## 2 Installation



This chapter takes Ninebot GoKart Pro as an example. The specific installation steps depend on the vehicle model.

### Install the Base

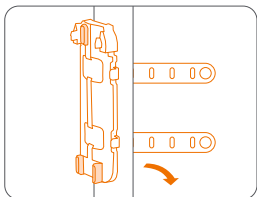

1. Place the base in a proper position (as shown above, the bracket hook is located below) and wrap the strap around the vehicle body.

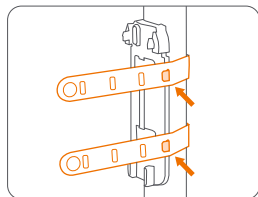

2. Fasten the strap on the strap hook of the base. Make sure it is firmly fastened.

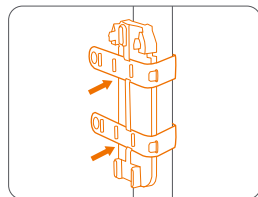

3. Press the remaining part of the strap into the storage slot.

### Install/Remove the Speaker

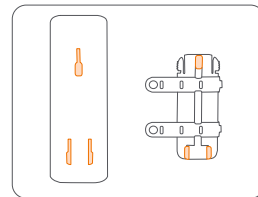

1. Align the holes on the bottom of the speaker with those in the base.

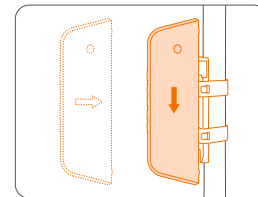

2. Press down until you hear a "clicking" sound.

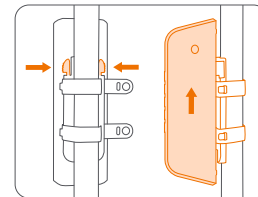

3. When removing the speaker, press the disassembly switch while lifting the speaker upward.

### 3 Connect to a Vehicle (Vehicle Mode)

NOTE: Please ensure that the vehicle to be connected is turned on and the firmware has been upgraded to the latest version in the Segway-Ninebot App.

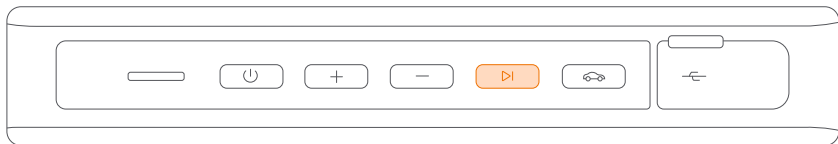
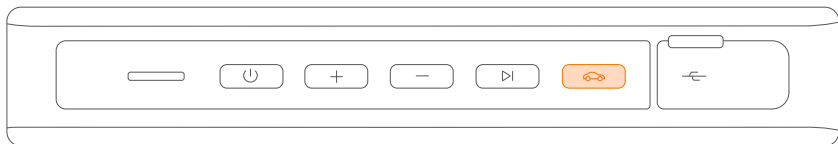
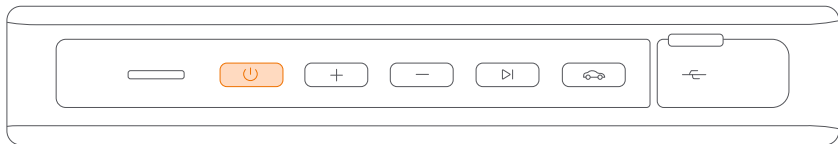

1. Press the power switch to turn on the speaker. The indicator is white by default. If the indicator is blue, please press the Mode button to switch to the white indicator.

Tip:

After powered on, the speaker has two modes: vehicle mode (white light with engine sound) and music mode (blue light with chord sound effect).

2. Press and hold the Mode button to start pairing. Please operate the vehicle according to the voice prompt to complete the pairing. Once the pairing succeeds, the speaker will automatically connect to the vehicle, and the indicator will be solid white. If the pairing fails, repeat this step.

Note:

- When connecting, please ensure that there is only one active vehicle within the range of the Bluetooth (about 10 m) and the Bluetooth of the vehicle is not connected, otherwise the connection may not be successful.
- If the vehicle to be connected is Ninebot eScooter or Ninebot eMoped, please disable the "Ninebot AirLock" function in Segway-Ninebot App, otherwise the speaker may not be connected.
- The speaker automatically connects the paired vehicle. If you need to connect the speaker to another vehicle, please repeat this step.

3. After the speaker is successfully connected, press "Next" to change the engine sound effect.

Tip:

The speaker has 4 kinds of engine sound effects: single-cylinder engine, double-cylinder engine, V8 engine and V12 engine.

## 4 Connect to a Mobile Phone (Music Mode)

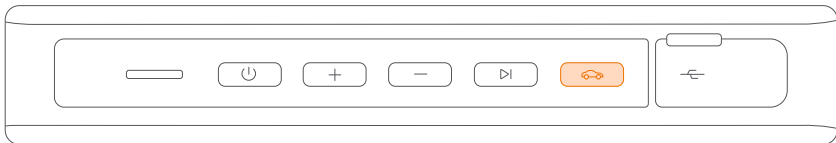
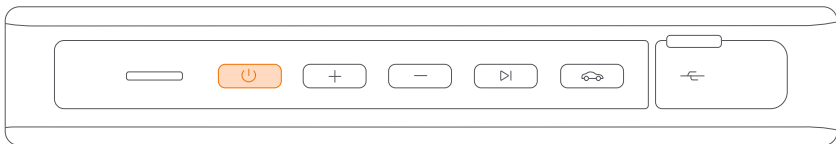

1. Press the power switch to turn on the speaker.
2. Short press the Mode button until the blue indicator is on and the chord sound effect is sounded.
3. Enable the Bluetooth on your mobile phone and connect to "Ninebot Engine Speaker". After pairing, the speaker can play music from your mobile phone.

## 5 Charging

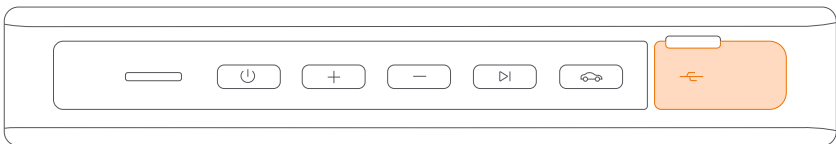

When the indicator flashes red, the speaker has low battery, please charge it immediately.

1. Open the rubber cover of the charging port;
2. Insert the charging cable to charge. The indicator is solid red during charging.
3. When the battery is full, the indicator will be solid green. Disconnect the charging cable when finished.



## 6 Button Functions

Button	Function 1	Function 2
Power switch	Short press to power on.	Long press to power off.
Volume +	Short press to increase the volume by one bar.	Long press to quickly increase the volume.
Volume-	Short press to reduce the volume by one bar.	Long press to quickly reduce the volume.
Next	In vehicle mode, short press to switch sound effects.	In music mode, short press to play/pause.
Mode switch	Short press to switch vehicle mode and music mode.	Long press to pair in vehicle mode.
		Long press to disconnect/restore Bluetooth connection in music mode.

## 7 Meanings of Indicators

	Indicator status	Meaning
Vehicle mode	White flashes quickly	Not pairing a vehicle
	White double flashes	Vehicle is pairing
	White flashes slowly	Pairing a vehicle but it is not connected successfully.
	Solid white indicator	Connected to the vehicle successfully
Music mode	Blue flashes slowly	Not connected to mobile phone in music mode
	Solid blue indicator	Connected to mobile phone in music mode
Charging status	Red flashes slowly	Low battery
	Solid red	Charging
	Solid green	Fully charged

## 8 Applicable models

Vehicle	Model
Self-balancing vehicles	Ninebot S
	Ninebot miniPRO
	Ninebot S-PLUS
	Ninebot Dynamic
	Ninebot S-Max
Kick scooter	Mi Electric Scooter
	Ninebot KickScooter ES1/ES2/ES3/ES4
	Ninebot KickScooter 22/E25/E45
Electric Motorbike	Ninebot KickScooter MAX
	Ninebot eScooter 80C*
	Ninebot eScooter 125*
	Ninebot eScooter 100*
	Ninebot eScooter 200P*
	Segway Dirt eBike X160
Ninebot GoKart	Segway Dirt eBike X260
	Ninebot GoKart Kit
	Ninebot GoKart Pro
Electric Bike	Ninebot Kart Pro (Lamborghini Edition)
	Ninebot eMoped C40*
	Ninebot eMoped C60*
	Ninebot eMoped C80*
	Segway Dirt eBike X160
Segway Dirt eBike X260	



Please scan the code to learn about more compatible models and how to pair

\*Please disable the "Ninebot AirLock" feature in the Segway Ninebot App, otherwise the speaker may not be connected.

## 9 Specifications

Product	Product name	Ninebot Engine Speaker
	Product model	BT2928
Basic information	Dimensions (length × width × height)	248 × 83 × 77 mm
	Net weight	715g
	IP rating	IP55
	Button functions	Power on/off, volume +, volume -, next, mode switching.
	Charging port	USB Type-C
Horn	Dimensions	50 × 50mm
	Material	NdFeB
	Specifications	20-core double magnetic trumpet
	Power	8W × 4
Bluetooth specification	Bluetooth protocol	HFPV1.6 HSPV1.2 A2DPV1.2 AVRCPV1.4 DIV1.3
	Bluetooth version	V 4.2 and above
	Frequency	2.4GHz-2.48GHz
	Working distance	Approx. 10 meters
Audio specification	Number of channels	Double channel
	Output power (Max)	8W × 4
	Rated power	5W × 4
	Frequency range	100Hz ~ 20KHz
	Signal to noise ratio	> 80dB (2W)
Battery specification	Rated capacity	2200mAh (7.4V)
	Play time	2~3h
	Charging voltage	5V, 3A
	Charging time	2.5h
Ambient temperature	Storage environment	-10~60 C
	Operating environment	-10~50 C

## 10 FAQs

Problems and Issues	Problems and Issues
Connection and pairing failure for multiple times	1. Check whether the speaker is paired or try to restart the speaker
	2. Check whether the vehicle is powered on or try restart the vehicle
	3. Are there any other applicable vehicles around? If yes, please turn them off.
	4. Check whether the Bluetooth of the vehicle is connected
Low volume or distorted sound	1. Check the volume and adjust to the appropriate value
	2. In case of low battery voltage, please charge the battery
Interrupted music	1. Is the vehicle out of the effective connection distance of the speaker
	2. There is obstacle between the speaker and the vehicle.
The speaker indicator is not on	1. Is the battery low?
	2. Charge the speaker and turn it on
The speaker indicator is not on	Contact the official after-sales service for support.

## 11 Precautions

### Instructions for Product Use

1. To avoid damage caused by falling, do not throw or cast the product
2. Do not disassemble, repair or modify the product. Avoid falling or being under heavy pressure.
3. Do not use or store the product in high temperature. Do not expose the product to rain or humid environment. Please do not store the product together with flammable, explosive and corrosive chemicals.
4. The product contains lithium battery, please do not put it in fire, so as not to cause danger! When discarding the product, please abide by local laws and regulations.
5. Do not touch the diaphragms on the left and right sides of the speaker

### Instructions for Users

1. In order to avoid hearing damage, please use medium or low volume when playing for a long time.
2. In order to prolong the service life of the battery, please charge it in time after each use. Do not wait until the battery runs out before recharging. Do not store the speaker for a long time under low battery.
3. When the product cannot be turned on, please connect it to the charger to charge for 10 minutes.
4. Do not clean the product when charging. This product should be powered off before cleaning.
5. To avoid damage to the product, please use the charger with an output voltage/current of 5 V/3 A

### Maintenance

1. The normal working temperature of the speaker should be  $-10\text{ }^{\circ}\text{C}$ – $50\text{ }^{\circ}\text{C}$ . Temperature extremes will accelerate the aging of electric components. Pay special attention to cooling and maintaining air circulation in summer.
2. Charge regularly. If the product is not used for a long time, especially in humid and high temperature seasons, it is best to charge it for half an hour every day. Prevent the internal coil, the speaker voice coil and the transformer from being damaged by humidity.
3. Regularly wipe the speaker surface with clean, wet and soft cotton cloth; When not in use, cover it with a dust cover or cloth to prevent dust from entering the speaker.

## 12 Trademarks and legal statements

Ninebot and Ninebot Electric are registered trademarks or trademarks of Ninebot (Beijing) Tech Co., Ltd.; Ninebot is a registered trademark of Ninebot (Tianjin) Tech Co., Ltd.; Segway and the Rider symbol are registered trademarks or trademarks of Segway Company. Xiaomi and MIJIA are registered trademarks or trademarks of Xiaomi Technology Co., Ltd.; Lamborghini is a registered trademark of Automobili Lamborghini Company; The respective owners reserve the rights of their trademarks referred to in this manual.

We have attempted to include description and instructions for all the functions of the Ninebot Engine Speaker at the time of printing. However, due to constant improvement of product features and changes of design, your speaker may differ slightly from the one shown in this document.

In addition to the BT2928 Ninebot Engine Speaker, Ninebot also has a number of series and models with different functions. Some of the features mentioned in this Manual may not be available on your other Ninebot products. Due to the product update, the products listed in this Manual may differ from the products you actually purchased in terms of color, appearance, etc. Please refer to the actual products.

2020 Ninebot (Beijing) Tech Co., Ltd. All rights reserved.

## 13 After-sales Policy

The after-sales service for Ninebot Engine Speakers is strictly in accordance with the Law of the People's Republic of China on Protection of Consumer Rights and Interests and the Product Quality Law of the People's Republic of China.

### I. Warranty Policy

- In case of any non-human damage or failure of Ninebot Engine Speaker within 7 days of receiving the product, consumers can choose to return, exchange or repair the products. Returns will be handled with valid purchase vouchers. (The said return service is only available when the fault product is sold separately, and no separate return service is provided when it is sold bundled with other products)
- In case of any non-human damage or failure of Ninebot Engine Speaker within 15 days of receiving the product, consumers can choose to return, exchange or repair the products. Note that gifts are not covered by this policy.
- Returning for the first 7 days is only applicable to goods sold on Ninebot's official e-commerce platform. Artificial damage and lack of attached spare parts are not covered by the return policy, and the logistics expenses incurred shall be borne by the consumer.
- One of the following two conditions shall be met:
  1. The package is not opened, and the packaging and speaker body are in good condition upon receipt of the product.
  2. The package has been opened after receipt, the speaker body and all accessories (such as the instruction, data cables, etc.) are in good condition, the product has no traces of use, and the secondary sales of the product will not be affected. Please consult customer service (400-607-0001) for specific standards.
- The warranty starting time is based on the purchase invoice, the order of Ninebot's official e-commerce platform or the date recorded by Ninebot Company's system in turn (the next day after the signature of the consumer can be regarded as the warranty starting date by the e-commerce platform).

Tip: It is recommended that you keep the packing boxes for at least 15 days from the day of receiving the product.
- See the following table for the warranty period of main body and various components:

Type	Warranty contents	Warranty period
Main body	Main body of the speaker	1 year
Accessories	Base, data cable	3 months

### II. Non-warranty Policy

1. The validity period of the Three Guarantees has expired
2. Damage caused by human factors
3. Damage caused by force majeure
4. Any damage caused by failure to use, maintain and adjust according to the requirements of the Manual
5. Invoice information does not match the product
6. Failure or damage caused by forced use of this product beyond normal use conditions
7. Dismantling or repairing the product by personnel without authorization of Ninebot Company
8. Malicious damage to the product serial number and product information, including blurring, tearing, tampering, etc.
9. Failure and damage caused by other problems other than the design, manufacture and quality of the product itself

### III. Return Policy

Type	Type	Type	Type	Type
Return of products	7 days	Functional or quality issues stipulated by national laws	After testing and confirming by Ninebot Company or authorized service provider, and issuing testing report to confirm that it is a commodity quality problem.	The warranty starting time is based on the purchase invoice, the order of Ninebot's official e-commerce platform or the date recorded by Ninebot Company's system in turn
Changing of products	15 days	Functional or quality issues stipulated by national laws	After testing and confirming by Ninebot Company or authorized service provider, and issuing testing report to confirm that it is a commodity quality problem.	The warranty starting time is based on the purchase invoice, the order of Ninebot's official e-commerce platform or the date recorded by Ninebot.

Note: If you need to return or exchange the product, please contact the dealer.

If you have any doubts, please visit the official website: [www.segway.com](http://www.segway.com)  
Customer service number: 400-607-0001 to 9

# 材质工艺: 128g 金东太空梭哑粉纸, 封面覆哑膜; 四色印刷+PANTONE 152 C+PANTONE Cool Gray 11C

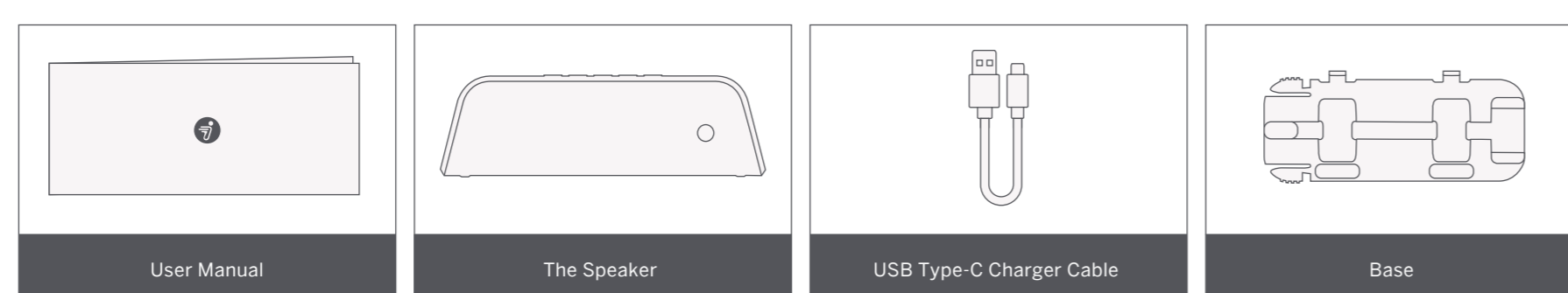

\*Please check the packaging contents carefully. In case of any missing or damaged items, please call the after-sales service.

## 1 Product Diagram

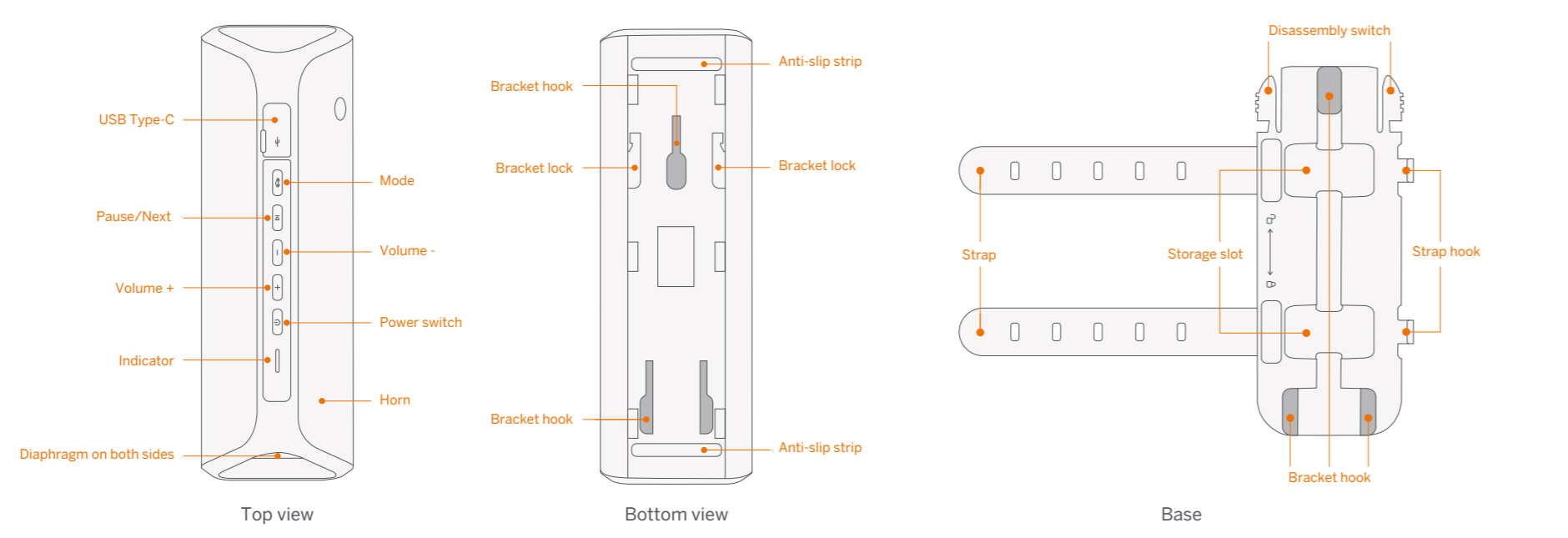

## 3 Connect to a Vehicle (Vehicle Mode)

NOTE: Please ensure that the vehicle to be connected is turned on and the firmware has been upgraded to the latest version in the Segway-Ninebot App.

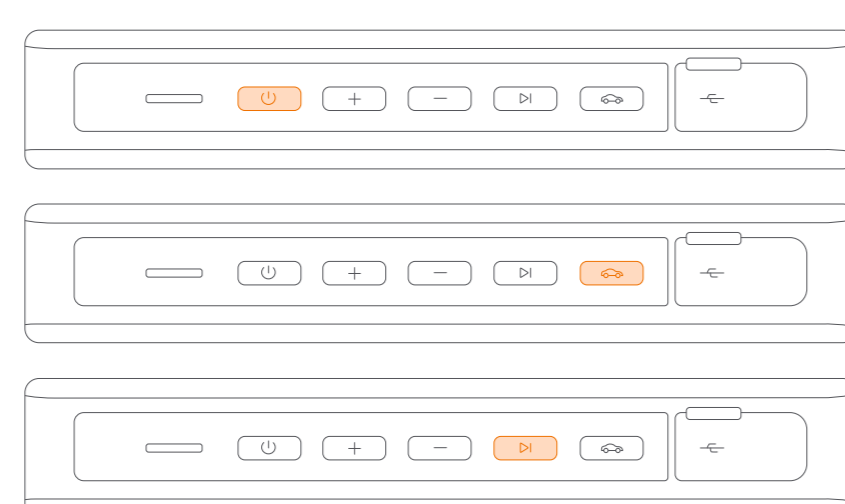

- Press the power switch to turn on the speaker. The indicator is white by default. If the indicator is blue, please press the Mode button to switch to the white indicator.
 

Tip: After power-on, the speaker has two modes: vehicle mode (white light with engine sound) and music mode (blue light with music sound effect).
- Press and hold the Mode button to start pairing. Please operate the vehicle according to the voice prompt to complete the pairing. Once the pairing succeeds, the speaker will automatically connect to the vehicle, and the indicator will flash white. If the pairing fails, repeat the step.

Note: When connecting, please ensure that there is only one active vehicle within the range of the Bluetooth (about 10m) and the Bluetooth of the vehicle is not connected, otherwise the connection may not be successful. If the vehicle is not connected, please check the "Vehicle Audio" function in Segway-Ninebot App, whether the speaker has not been connected. The speaker will automatically connect the paired vehicle, if you need to connect the speaker to another vehicle, please repeat the step.
- After the speaker is successfully connected, press "Next" to change the engine sound effect.
 

Tip: The speaker has 4 kinds of engine sound effects: single-cylinder engine, double-cylinder engine, V6 engine and V2 engine.

## 6 Button Functions

Button	Function	Function
Power switch	Short press to power on	Long press to power off
Volume+	Short press to increase the volume by one bar	Long press to quickly increase the volume
Volume-	Short press to reduce the volume by one bar	Long press to quickly reduce the volume
Mode	In-vehicle mode, short press to switch sound effects	In music mode, short press to play music
Mode	Short press to switch vehicle mode and music mode	Long press to connect/reconnect Bluetooth connection to music mode

## 7 Meanings of Indicators

Indicator status	Indicator	Meaning
White flashes quickly	White light	Not pairing or white
White flashes slowly	White light	White light
White flashes quickly	White light	Pairing vehicle but is not connected successfully
White flashes slowly	White light	Connected to the vehicle successfully
Blue flashes quickly	Blue light	Not connected to music phone in music mode
Blue flashes slowly	Blue light	Connected to music phone in music mode
Red flashes quickly	Red light	Low battery
Red flashes slowly	Red light	Charging
Solid green	Green light	Fullly charged

## 11 Precautions

- To avoid damage caused by falling, do not throw or cast the product.
  - Do not disassemble, repair or modify the product. Avoid being in strong under heavy pressure.
  - Do not use or store the product in high temperature. Do not expose the product to direct sunlight environment. Please do not store the product in places with high humidity, explosive and corrosive objects.
  - The product contains lithium battery, please do not put it in fire, as well as not to cause damage! When disassembling the product, please make it back later and reassemble.
  - Do not touch the disassembled on the left and right sides of the speaker.
- ### Instructions for Users
- In order to prolonging service life of the battery, please charge it in time after each use. Do not wait until the battery level is very low before charging. Do not store the speaker for a long time.
  - When the product cannot be turned on, please connect it to the charger to charge for 30 minutes.
  - Do not clean the product when charging. The product should be powered off when cleaning.
  - To avoid damage to the product, please use the charger with an output voltage/current of 5 V/3 A.
- ### Maintenance
- The normal operating temperature of the speaker should be 10°C-40°C. Temperature extremes will affect the aging of electronic components. Pay special attention to cooling and maintaining or ventilation in summer.
  - Charge regularly. If the product is not used for a long time, especially in humid and high temperature season, it is best to charge for half an hour every day. Prevent the internal coil, the speaker voice coil and the transformer from being damaged by humidity.
  - Regularly wipe the speaker surface with clean, well-wet soft cotton cloth. When not in use, cover it with a dust cover or cloth to prevent dust from entering the speaker.

## 8 Applicable models

Series	Model
Self-balancing vehicles	Ninebot S1
	Ninebot S1E
	Ninebot S1E Plus
	Ninebot S1E Pro
	Ninebot S1E Pro Max
Kick scooter	Ninebot Kick Scooter ES1/ES2/ES3/ES4
	Ninebot Kick Scooter ES2/ES3/ES4
	Ninebot Kick Scooter ES2/ES3/ES4
	Ninebot Kick Scooter ES2/ES3/ES4
	Ninebot Kick Scooter ES2/ES3/ES4
Electric kick scooter	Ninebot Kick Scooter ES2/ES3/ES4
	Ninebot Kick Scooter ES2/ES3/ES4
	Ninebot Kick Scooter ES2/ES3/ES4
	Ninebot Kick Scooter ES2/ES3/ES4
	Ninebot Kick Scooter ES2/ES3/ES4
Ninebot G-Series	Ninebot G1
	Ninebot G1 Pro
	Ninebot G1 Pro Max
	Ninebot G1 Pro Max
	Ninebot G1 Pro Max
Electric bike	Ninebot G1
	Ninebot G1 Pro
	Ninebot G1 Pro Max
	Ninebot G1 Pro Max
	Ninebot G1 Pro Max

## 12 Trademarks and legal statements

Ninebot and Ninebot Electric are registered trademarks or trademarks of Ninebot (Segway) Tech Co., Ltd. in the United States and other countries. Ninebot is a registered trademark of Segway Technology Co., Ltd. in the United States and other countries. Ninebot is a registered trademark of Segway Technology Co., Ltd. in the United States and other countries. The respective owners reserve the rights of these trademarks referred to in this manual.

We have attempted to include descriptions and instructions for all the functions of the Ninebot Engine Speaker in this manual. However, due to constant improvement of product features and changes of design, other functions may not be included in this manual. Please refer to the product manual for the latest information.

In addition to the Ninebot Engine Speaker, Ninebot also has a number of series and models with different functions. Some of the features mentioned in this manual may not be available in your other Ninebot products. Due to the product update, the product listed in this manual may differ from the products you actually purchased in terms of color, appearance, etc. Please refer to the actual products.

©2020 Ninebot (Segway) Tech Co., Ltd. All rights reserved.

## Contents

1 Product Diagram	1
2 Installation	2
3 Connect to a Vehicle (Vehicle Mode)	3
4 Connect to a Mobile Phone (Music Mode)	4
5 Charging	5
6 Button Functions	6
7 Meanings of Indicators	7
8 Applicable Models	8
9 Specifications	9
10 FAQs	10
11 Precautions	11
12 Trademarks and Legal Statements	12
13 After-sales Policy	13

## 2 Installation

This chapter takes Ninebot G-Series Pro as an example. The specific installation steps depend on the vehicle model.

### Install the Base

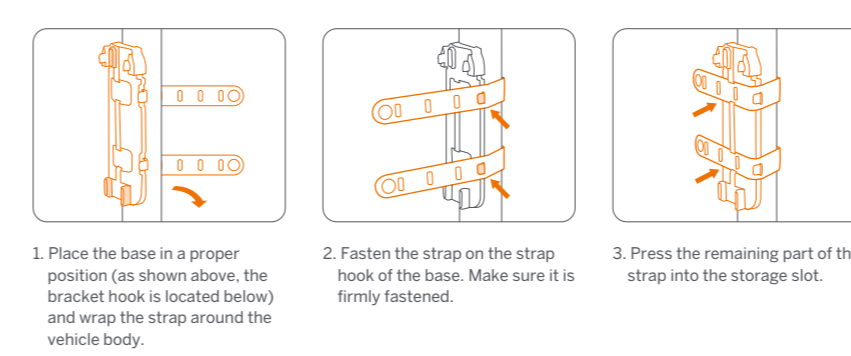

- Place the base in a proper position on the vehicle. The bracket hole is located below the base and the strap should be fixed to the vehicle body.
- Fasten the strap on the strap hole of the base. Make sure it is fixed to the vehicle body.
- Press the remaining part of the strap into the storage slot.

### Install/Remove the Speaker

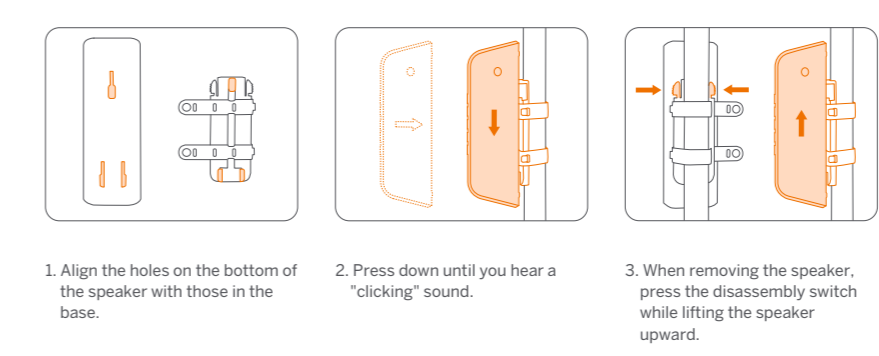

- Align the base on the bottom of the speaker with those in the base.
- Press down until you hear a "clicking" sound.
- When removing the speaker, press the disassembly switch with the speaker upward.

## 4 Connect to a Mobile Phone (Music Mode)

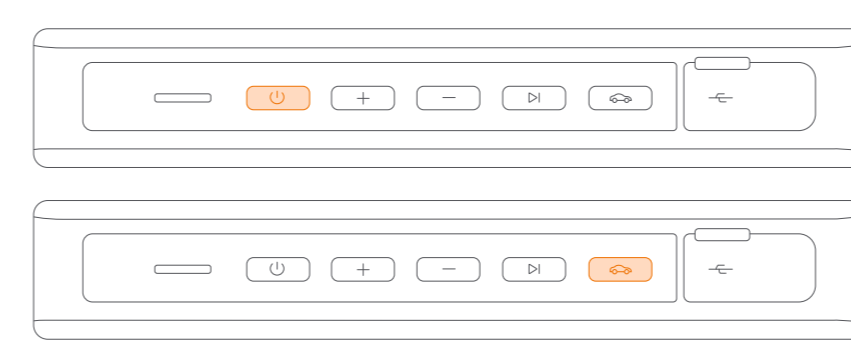

- Press the power switch to turn on the speaker.
- Short press the Mode button until the blue indicator is on and the chord sound effect is sounded.
- Enable the Bluetooth on your mobile phone and connect to "Ninebot Engine Speaker". After pairing, the speaker can play music from your mobile phone.

## 5 Charging



- Open the rubber cover of the charging port.
- Insert the charging cable to charge. The indicator is solid red during charging.
- When the battery is full, the indicator will be solid green. Disconnect the charging cable when finished.

## 9 Specifications

Product	Product name	Ninebot Engine Speaker
Product name	Product name	Ninebot Engine Speaker
	Product name	Ninebot Engine Speaker
Basic information	Dimensions (length x width x height)	117 x 72 x 72 mm
	Net weight	170g
Material	Material	ABS
	Material	ABS
Horn	Horn	1 x 2 and 2 x 2
	Horn	1 x 2 and 2 x 2
Bluetooth specification	Bluetooth version	Bluetooth 4.2
	Bluetooth version	Bluetooth 4.2
Audio specification	Frequency range	200Hz - 20000Hz
	Frequency range	200Hz - 20000Hz
Battery specification	Battery type	Li-ion battery
	Battery type	Li-ion battery
After-sales information	Warranty period	1 year
	Warranty period	1 year

## 10 FAQs

Problem and reason	Problem and reason
Connection error when pairing with mobile phone	1. Check whether the speaker is powered on or not. 2. Check whether the phone is powered on or not. 3. Are there any other Bluetooth devices around? If yes, please turn them off. 4. Are there any other Bluetooth devices around? If yes, please turn them off. 5. Are there any other Bluetooth devices around? If yes, please turn them off.
Low volume or distorted sound	1. Check the volume and adjust to the appropriate value. 2. Is the volume of the phone connected to the speaker? 3. Is there any other Bluetooth device around? 4. Is there any other Bluetooth device around?
Intermittent sound	1. Is the battery low? 2. Is the battery low? 3. Is the battery low?
The speaker indicator is not on	1. Is the battery low? 2. Is the battery low?
The speaker indicator is not on	1. Is the battery low? 2. Is the battery low?

## 13 After-sales Policy

The after-sales service for Ninebot Engine Speaker is provided in accordance with the law of the People's Republic of China and the Protection of Consumer Rights and Interests and the Product Quality Law of the People's Republic of China.

### Warranty Policy

- General warranty: The speaker is covered by a 1-year warranty from the date of purchase. The warranty is void if the product is damaged due to misuse or accident.
- Exclusion of warranty: The speaker is not covered by the warranty if the product is damaged due to misuse or accident.
- Replacement: If the product is found to be defective within the warranty period, the speaker will be replaced with a new one of the same model.
- Repair: If the product is found to be defective within the warranty period, the speaker will be repaired with a new one of the same model.
- Refund: If the product is found to be defective within the warranty period, the speaker will be refunded with a new one of the same model.

Note: The warranty policy is subject to the actual product and the actual situation. Please refer to the actual product for the latest information.

## II. Non-warranty Policy

The speaker is not covered by the warranty if the product is damaged due to misuse or accident.

- The speaker is not covered by the warranty if the product is damaged due to misuse or accident.
- The speaker is not covered by the warranty if the product is damaged due to misuse or accident.
- The speaker is not covered by the warranty if the product is damaged due to misuse or accident.
- The speaker is not covered by the warranty if the product is damaged due to misuse or accident.
- The speaker is not covered by the warranty if the product is damaged due to misuse or accident.

Note: If you need to return or exchange the product, please contact the dealer.

Method	Return address	Return period
Online	www.ninebot.com	1 year
Offline	www.ninebot.com	1 year

## **FCC STATEMENT :**

This device complies with Part 15 of the FCC Rules. Operation is subject to the following two conditions:

- (1) This device may not cause harmful interference, and
- (2) This device must accept any interference received, including interference that may cause undesired operation.

**Warning:** Changes or modifications not expressly approved by the party responsible for compliance could void the user's authority to operate the equipment.

NOTE: This equipment has been tested and found to comply with the limits for a Class B digital device, pursuant to Part 15 of the FCC Rules. These limits are designed to provide reasonable protection against harmful interference in a residential installation. This equipment generates uses and can radiate radio frequency energy and, if not installed and used in accordance with the instructions, may cause harmful interference to radio communications. However, there is no guarantee that interference will not occur in a particular installation. If this equipment does cause harmful interference to radio or television reception, which can be determined by turning the equipment off and on, the user is encouraged to try to correct the interference by one or more of the following measures:

- Reorient or relocate the receiving antenna.

- Increase the separation between the equipment and receiver.

- Connect the equipment into an outlet on a circuit different from that to which the receiver is connected.

- Consult the dealer or an experienced radio/TV technician for help.

## **FCC Radiation Exposure Statement:**

This equipment complies with FCC radiation exposure limits set forth for an uncontrolled environment. This equipment should be installed and operated with minimum distance 20cm between the radiator & your body.