

# TOTAL

One-Stop Tools Station

TOTAL

## CONCRETE VIBRATOR

TP630-1, TP630-2, TP630-2E  
TP630-12, TP630-22, TP630-22E



 totaltoolsworld  
 TOTAL TOOLS WORLD



## SPECIFICATIONS

Model	TP630-1	TP630-2	TP630-2E
Engine Type	Air-cooled, 4-storke, single cylinder,petrol		
Engine Model	Petrol,Honda GX160	Petrol,TOTAL	Petrol,TOTAL
Power kW(HP)	4.0 (5.5)	4.0 (5.5)	4.8 (6.5)
Coupling Type	Claw		

Model	TP630-12	TP630-22	TP630-22E
Engine Type	Air-cooled, 4-storke, single cylinder,petrol		
Engine Model	Petrol,Honda GX160	Petrol,TOTAL	Petrol,TOTAL
Power kW(HP)	4.0 (5.5)	4.0 (5.5)	4.8 (6.5)
Coupling Type	Hex		

## GASOLINE ENGINE VIBRATOR

When the gasoline engine vibrator is used for concrete members that are blended with a concrete mixer, the air bubbles must be removed, and tamp the concrete to make it compact, eliminating voids and pits. It helps to improve its strength, and ensure the quality of concrete members. The concrete vibrator is a mechanized tool for tamping concrete.

### Use, Notices and Maintenance of Vibrators

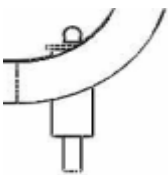

1. Before operating, first insert the latch on the gasoline engine frame into the base.
2. Insert and fix the Vibrator into the coupling.
3. While the vibrator is working, the vibrator shall be inserted vertically or aslant into the concrete, and vibrate for a while before use. The vibrator shall move up and down.
4. For concrete in layer on members or structures, the vibrator shall be inserted into the layer which has been vibrated for the next layer to eliminate gap between layers, obtaining the overall effect.
5. After half an hour of continuous work, the vibrator shall stop for a period of time to prevent mechanical damage due to over heat.
6. In order to protect hoses, the bend radius shall not less than 500MM.
7. The vibrator shall be taken apart every 50-100hrs to have all parts cleaned. First twist off the head and horse connector (both with left screw), knock the large-diameter extended rolling cone with a wooden hammer, and take out the rolling cone, bearing, oil seals, etc. And then remove the hose connector (with right screw). Now, you can take off all the parts.

8. After cleaning, replace damaged parts, and then reassemble the vibrator. Except the bearing, the oil on all parts must be removed. Ensure the rolling cone surface and casing free of any oil.

9. The screw connection on the end of vibrator must be threaded tightly to prevent mortar water from entering the vibrator, stopping its vibration.

10. If the vibrator doesn't work or lacks strength, you may take apart the vibrator to check for the oil seal. If the oil seal is in good condition, then remove the oil in the casing and on the rolling cone surface. The best materials used in hardware hose and fittings feature largely in a quality vibrator. The software assembly requires high technical requirements. The vibrator seems simple, but in order to achieve very low return rate, the installer is never too careful. The material shall be replaced immediately even if there is only a tiny material issue. The fittings shall be thickened at ends to protect the hose to make it difficult to break off, and to achieve stable quality, long wear time, and high vibration force; at the same time, the vibrator head made of quality steel has good wear resistance, even if it breaks, with replacement of fittings and repair, the vibrator can work as a new one. Compared with similar products available in market, this vibrator has a significantly longer service life.

11. The gasoline engine vibrator shall not be placed under no-load running for a long time. In manufacturing operation, a firm and reliable form clamping device is required to ensure the form vibrates with the concrete countertop.

12. The gasoline engine vibrator shall be kept clean and neat to maintain good contact with steel form. As the countertop can easily crack under vibration at high frequency and heavy load, please provide regularly check and timely repair. Every shift shall clean the vibrator after the completion of work.

**TP630-1,TP630-2,TP630-12,TP630-22,TP630-2E  
TP630-22E Spare part list**

No.	Part Description	Qty
1	Engine	1
2	M8 locknut	4
3	Protective frame	1
4	M8x35 hexagonal screw	4
5	Base plate	1
6	Coupling core	1
7	Coupling cover	1
8	Coupling Assy (Claw--TP630-1/TP630-2/TP630-2E),(Hex--TP630-12/TP630-22/TP630-22E)	1
	Options:coupling Assy (Claw--TP630-1/TP630-2/TP630-2E),(Hex--TP630-12/TP630-22/TP630-22E)	1
9	M8x20 hexagonal screw	4
10	Vibrator head	1



# TP630-1, TP630-2, TP630-12, TP630-22, TP630-2E TP630-22E Exploded view

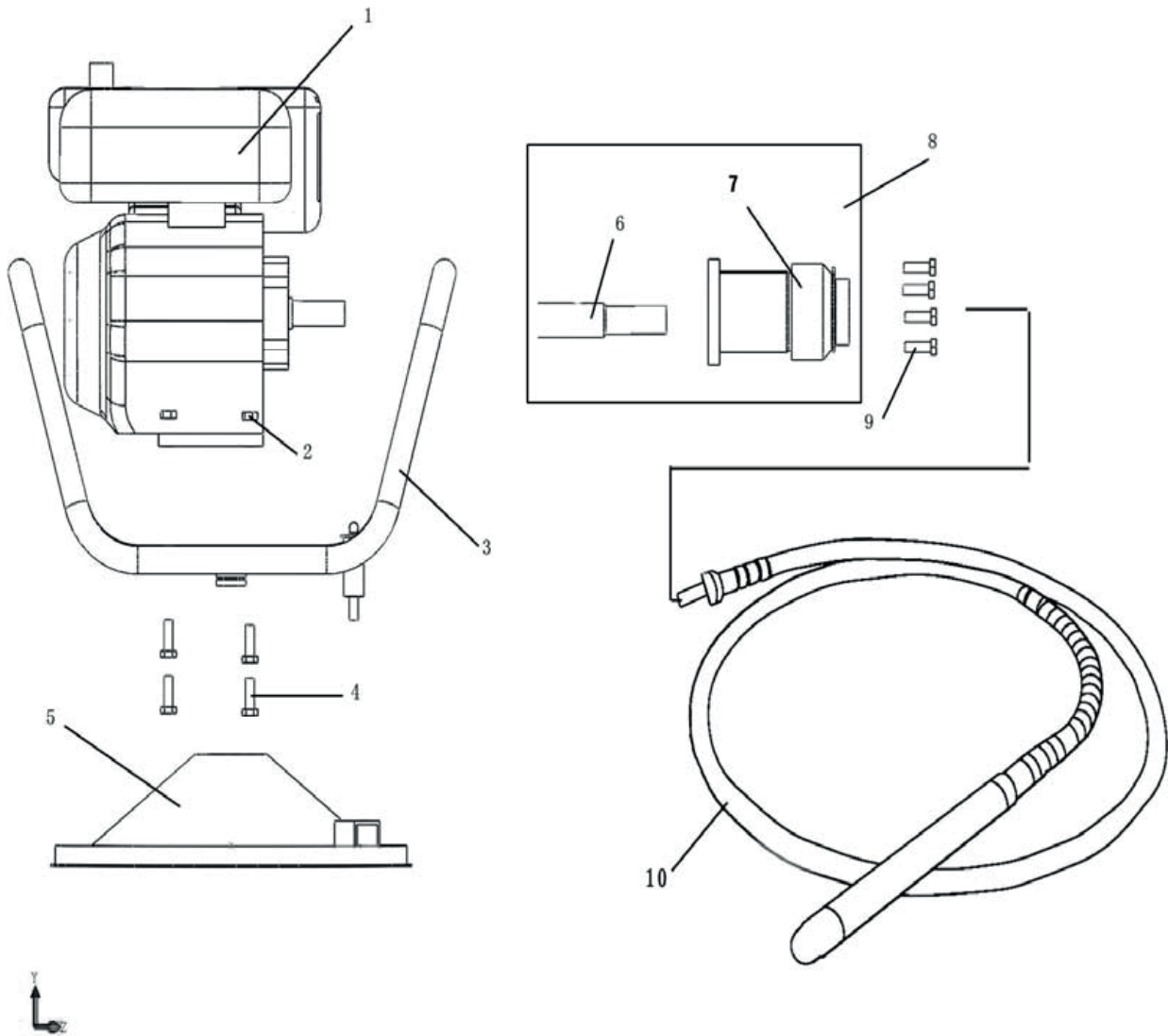

# TOTAL

One-Stop Tools Station

TOTAL

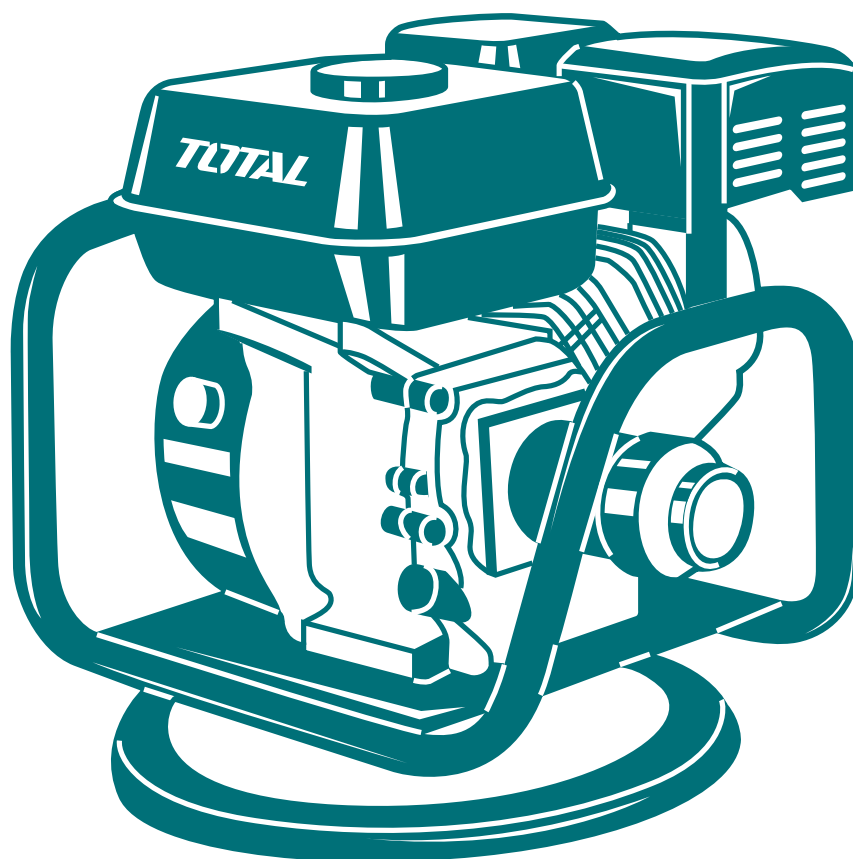

**CONCRETE VIBRATOR**

[www.totaltools.cn](http://www.totaltools.cn)  
TOTAL TOOLS CO., LIMITED  
MADE IN CHINA  
T1019.V04