

TOTAL

One-Stop Tools Station

TOTAL

VACUUM CLEANER

UTVC14301

INDUSTRIAL



1400W



SAFETY DIRECTIONS

Check before operation that the local power supply is the same as the specification on the rating label

This appliance is for household, hotel and similar place only.

Keep the machine away from ovens, stoves, etc.

Do not use vacuum cleaner to pick up burning, hot objects. Such as coal and ash, glowing cigarettes and match, etc.

Do not use vacuum cleaner to pick up large sharp objects.

Do not wrest, tramp or haul the hose. Do not use if the hose is broken.

Do not pick up volatile liquid, combustible gas, explosive garbage, etc.

Industrial or commercial use may damage the machine and may invalidate the warranty.

Do not use without filter and bag in place.

The plug of the power cord must be removed from the wall socket before changing the bag, cleaning the appliance or undertaking any maintenance operations, Never pull the vacuum cleaner by its cord when moving.

Do not let children use the machine.

If there is foam or liquid out of machine when picking up water, please turn off the machine immediately.

If the power cord becomes damaged, do not use the vacuum cleaner, it must be replaced by an authorized service agent.

UTVC14301

- Rated Power: 1400W
- Rated Voltage: 110-120V~60Hz
- Dust Capacity: 30L
- Vacuum Pressure: 16-18Kpa
- Air Flow: 1.8-1.9m³/min
- Noise: 19-83dB(A)
- Cable Length(total): 2.3m

PARTS NAME

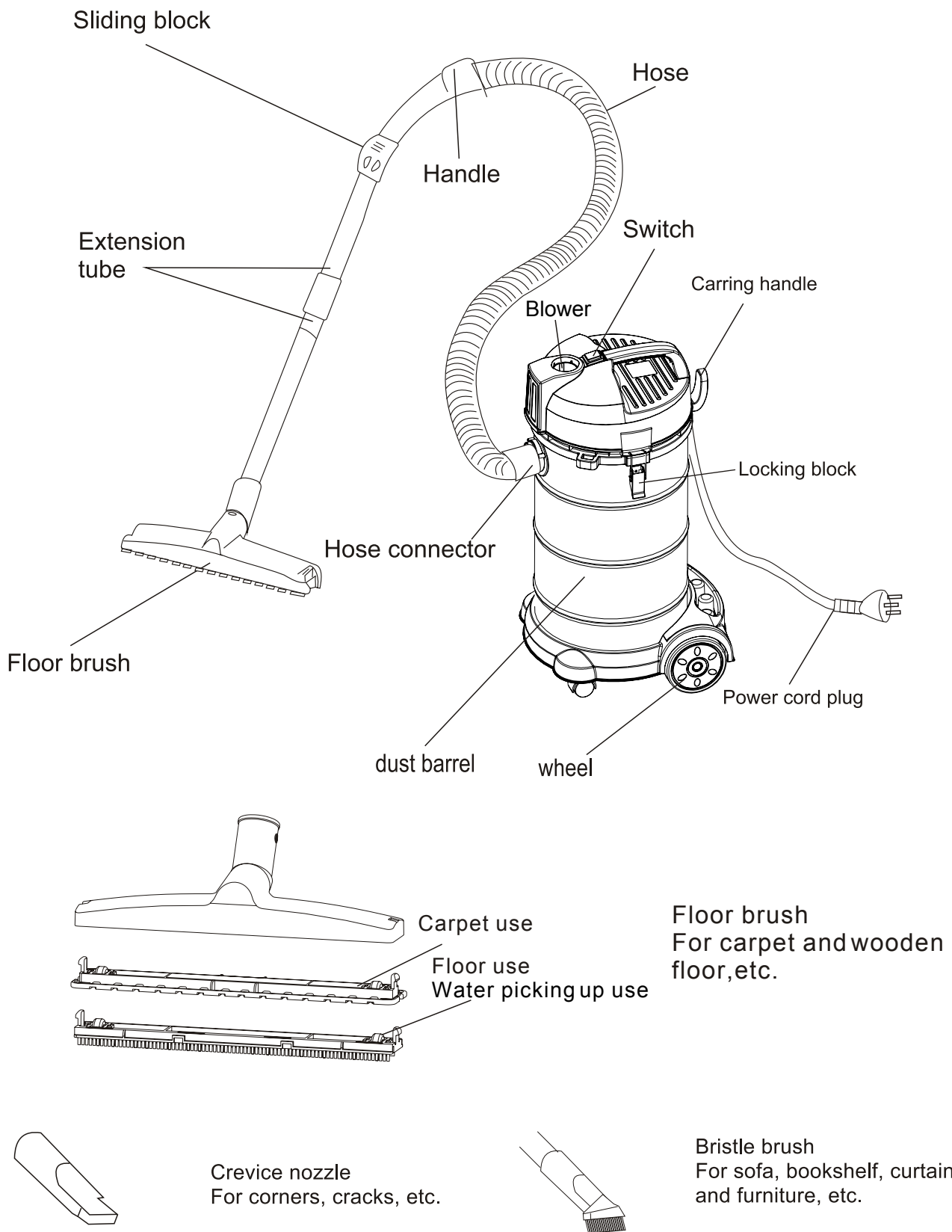

OPERATION METHOD

1

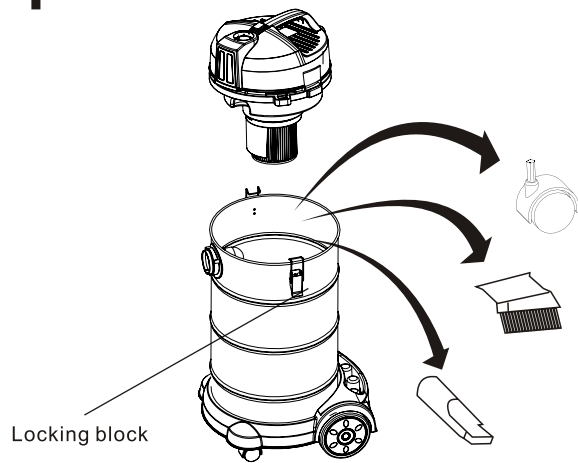

Release the lock block to open the up housing, take out wheels and accessories.

2

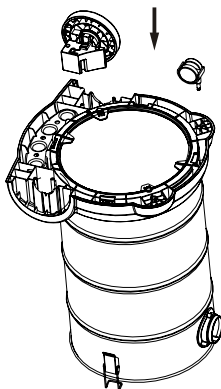

1. Install castor wheels into the hole on the base.
2. Install the big wheel into the relevant position and then fix the wheel with screw.
(Please kindly keep the mark on the big wheel ("R" or "L") same as the one ("R" or "L") on wheel base.)

3

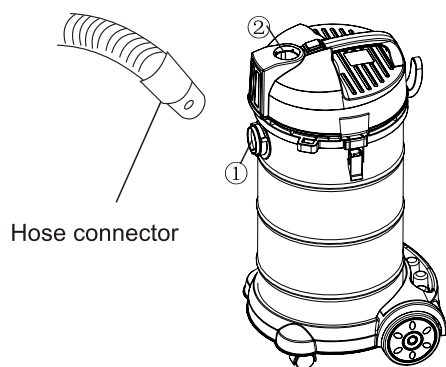

Put the hose connector into ①, the suction function is available
Put the hose connector into ②, the blow function is available

OPERATION METHOD

1

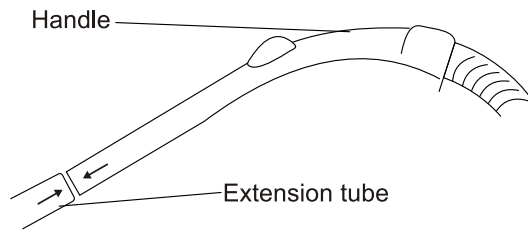

Insert the handle into the tube with a twisting force.

2

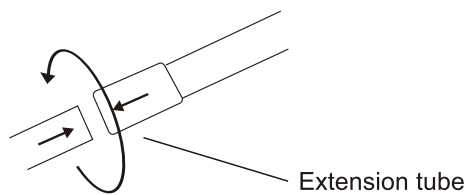

Same as above.

3

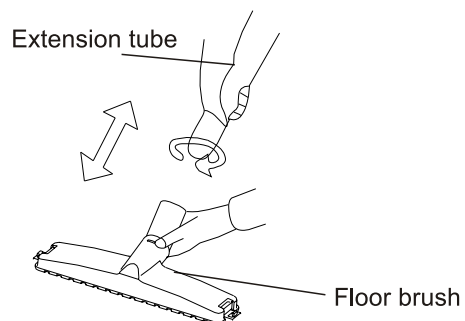

Same as picture one.

4

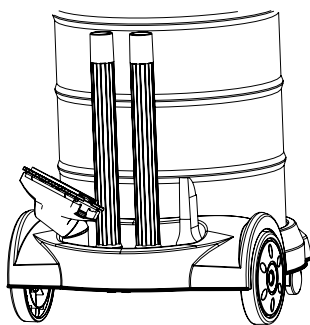

Dual storage

OPERATION METHOD

1

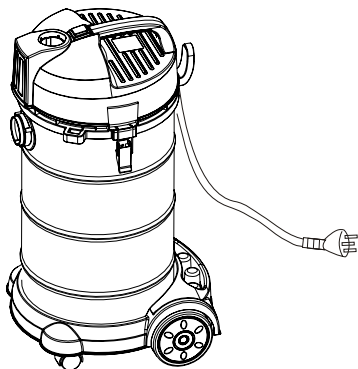

Hold the plug and insert into socket

2

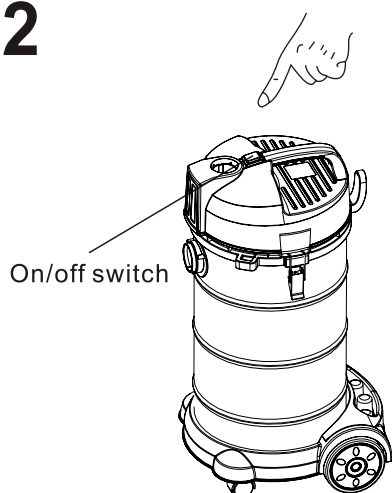

Press the switch button to turn on/off the cleaner

To be safe, there is a water-proof switch cover. Please replace the water-proof cover once find it broken.

3

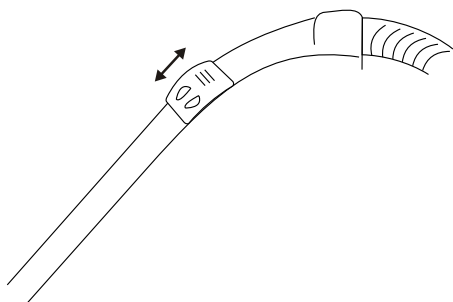

You can adjust the airflow by push the sliding block up and down.

TO REPLACE DUST BAG

If the dust barrel is full, please empty it as soon as possible

1

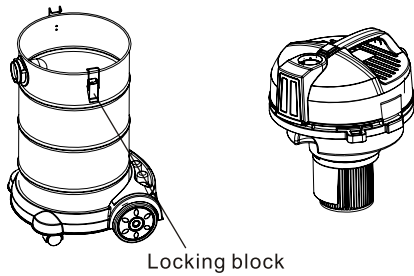

Release the lock block to open the up housing

2

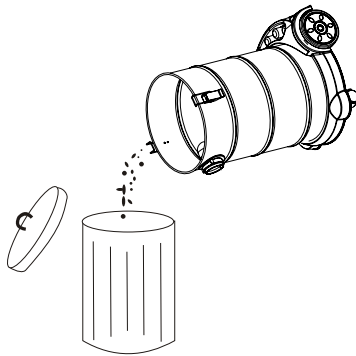

Empty the dust barrel

3

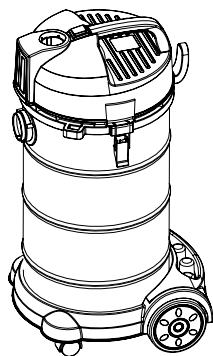

Put back the up housing, and fasten the locking block

MAINTENANCE

Warning: When the filters are obviously covered with dust or the suction decreases considerably, please clean it in time, for this can improve the working efficiency and extend the life time of the cleaner.

Never use the machine without filters.

1 Tear off the mesh

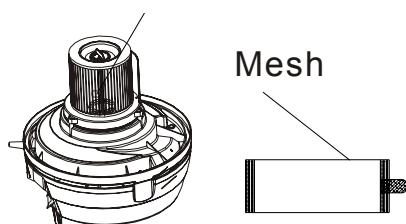

Tear off the mesh outside the HEPA filter

2

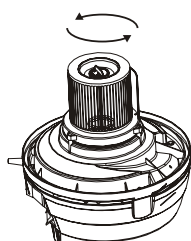

Twist the locking knob with a anti-clockwise force, take off the filters

3

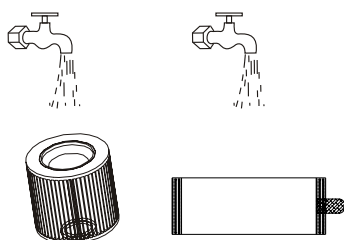

Clean it carefully

4

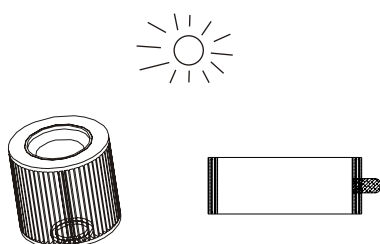

Dry by airing

5

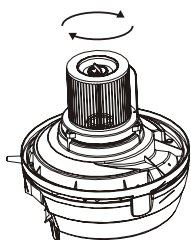

Put back the filter.

UTVC14301 Exploding view

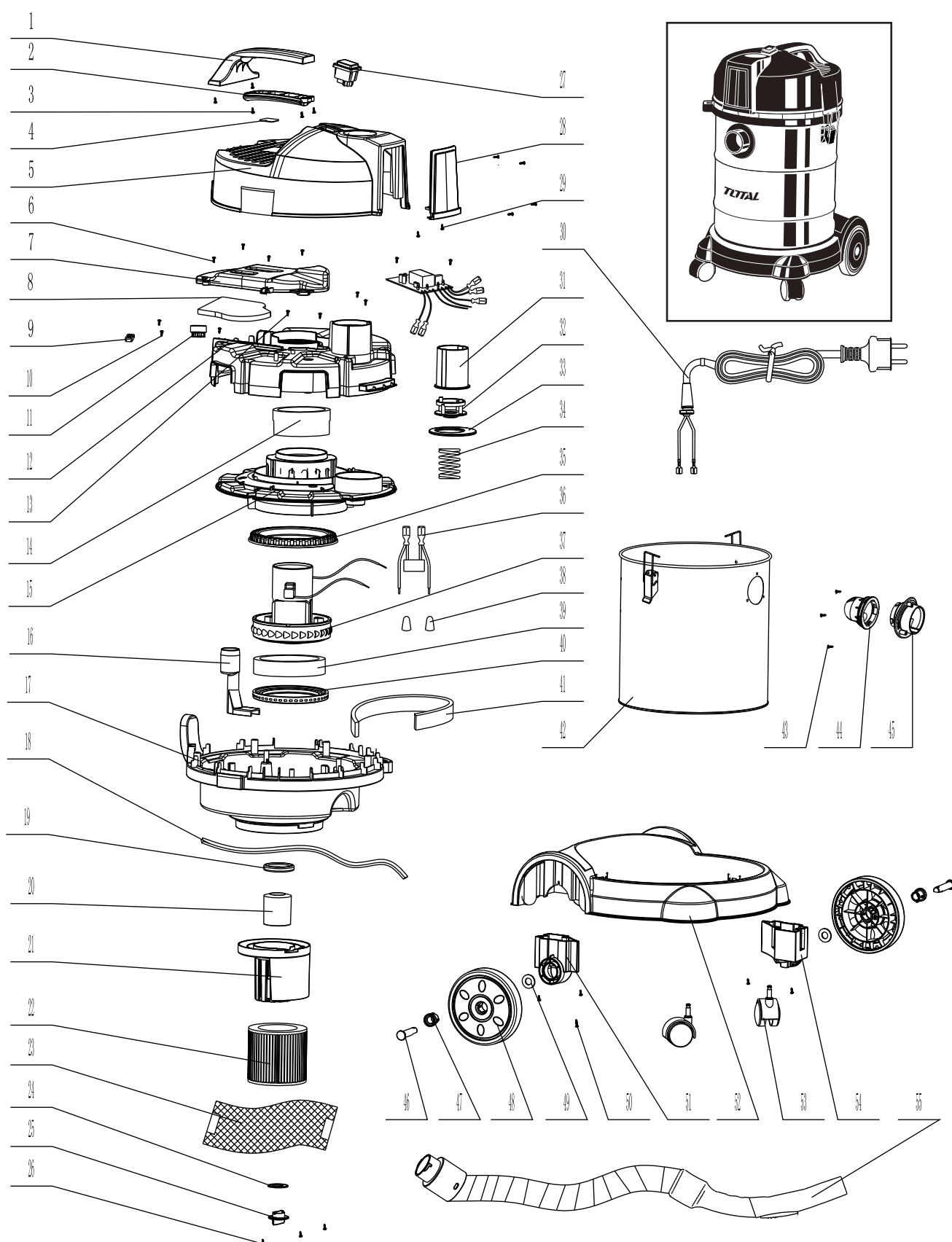

UTVC14301 Spare part list

No.	Part Description	Qty	No	Part Description	Qty
1	handle	1	29	screw	2
2	handle base	1	30	power cord	1
3	screw	5		plug(jl201)	1
4	rating label	1		plug(bs)	1
5	top cover	1	31	air pipe	1
6	screw	4	32	air valve	1
7	air inlet gland	1	33	valve plug	1
8	motor top cover sponge	1	34	valve spring	1
9	power cord nip	1	35	motor seal ring of air outlet	1
10	screw	2	36	motor wire connecting line	1
11	Safety valve assy	1	37	motor	1
12	Motor top cover	1	38	connection cap	2
13	screw	5	39	sponge	1
14	sponge	1	40	isolation seal ring	1
15	motor middle case	1	41	sponge	1
16	air flow pipe	1	42	bucket	1
17	motor base plate	1	43	st3.9x12	3
18	seal	1	44	sucktion port base	1
19	seal ring	1	45	sucktion port cover	1
20	floating ball	1	46	axle	2
21	mesh enclosure	1	47	axle sleeve	2
22	HEPA frame	1	48	big wheel	2
23	Strainer	1	49	flat washer	2
24	seal ring	1	50	st3.9*25	2
25	latch segment	1	51	right wheel base	1
26	screw	2	52	pedestal	1
27	switch	1	53	small wheel	2
28	Decoration Cover	1	54	left wheel base	1
			55	left wheel base	1

TOTAL

One-Stop Tools Station

TOTAL

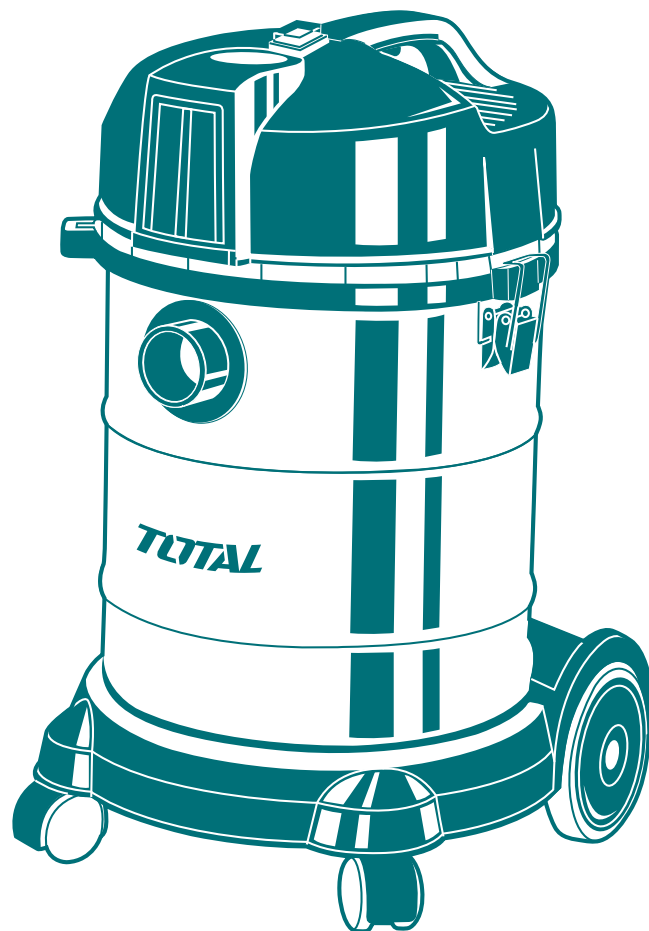

VACUUM CLEANER

www.totaltools.cn
TOTAL TOOLS CO., PTE. LTD.
MADE IN CHINA
T1118.V06

1400W