

Technical Data Sheet

Model

T1C 803-2

Housing material		Casting iron
Phase		Three
Frame size		80
Power(60Hz)	kW	1.50
Power(60Hz)	HP	2.01
Current(A)220V	Y Y	6.57
Current(A)440V	Y	3.28
Speed(60Hz)	(r/min)	3410
Efficiency	IE1	
	Eff.100%	81.00
Power factor cosφ	100% load	0.74
Service duty		S1
Service Factor		1.15
Enclosure		TEFC
Regulations		IEC / DIN / ISO / VDE / EN
Standard		IEC 60034
Ambient Temp.		-20°C ~ +40°C
Maximum altitute		1000 m above sea level

Rated torque(N.m)	4.20
Tst/Tn (Times)	2.2
Tmax/Tn (Times)	2.3
Tmin/Tn (Times)	1.8
Ist/In (Times)	7
Bearings type(DE)	6204-2RZ
Bearings type(NDE)	6204-2RZ
Oil seals	20*34*7
Cable glands	1-M20*1.5
Insulation class	F
Protection degree	IP 55
Thermal protection	Without
Rotation direction	Clockwise
Balance	Half-key balanced
Cooling	IC 411
Noise dB(A)	73
Net weight(kg)	18.00
Moment of inertia kg*m ²	0.001310000

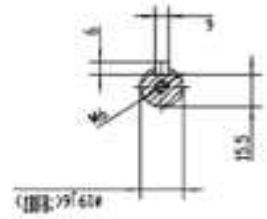
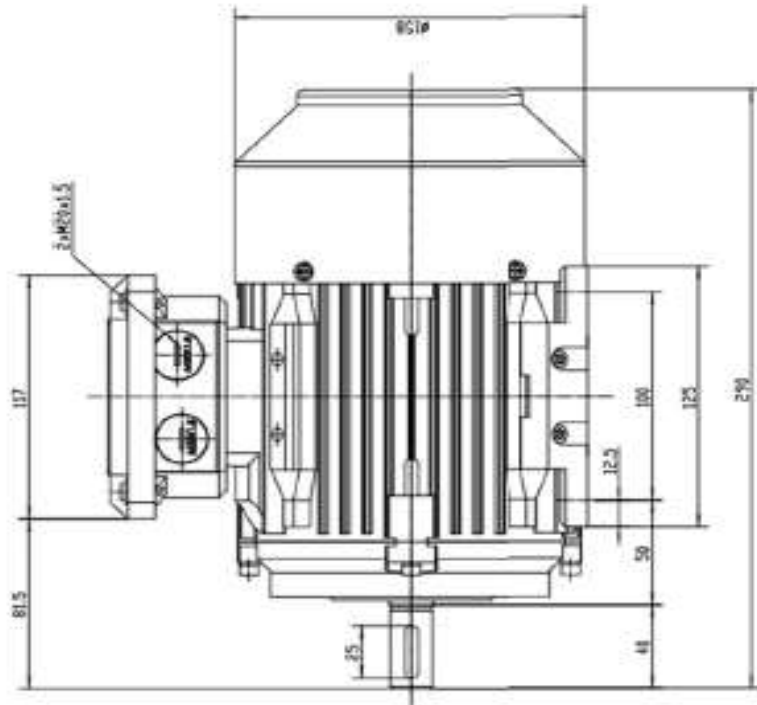
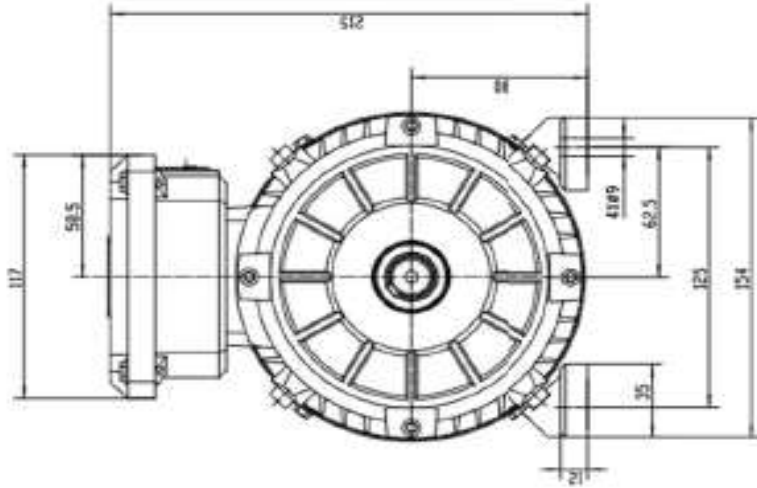

TC 80 B3

TC 80 B3		NO:	CY201.A16.001
Design Number	11.5	STEP MADE	1.5
Material	Cast Iron	Motor	Cast Iron Motor
Balling			